

STAINLESS STEEL QUICK COUPLING - 1/4» INDUSTRIAL PROFILE

Female plug - Stainless Steel

Profile : ISO 6150B

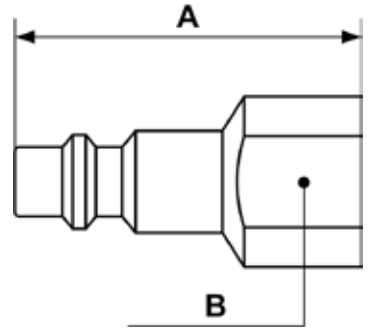

Min/max operating pressure 0 / 174 psi	Flow rate at 87 psi 28 CFM	ID passage 1/4"	Temperature min/max 5 / 158 °F
--	--------------------------------------	---------------------------	--

Part number	Female thread	Net weight (Kg)	Dim. A (inch)	Dim. B (inch)
PROXI 066101	G1/4	0,031	1.57	0.67